

# PVC COATED ALUMINUM YARD ELBOWS

## Features:

- Exterior PVC coating thickness is a minimum 0.040"
- Interior Urethane coating thickness is a minimum 0.002"
- NPT thread with end-cap on each end
- Sizes available are ½" to 4"

## Applications:

Calbond PVC Coated Aluminum Aluminum Yard Elbows feature 40 mil PVC exterior coating with 2 mil urethane coating on the interior. Yard elbows are used in stub up applications.

## Standards:

- UL/CUL listed in accordance to UL6A & ANSI C80.5 Standards
- UL/cUL listed rigid ferrous metal conduit with polyvinyl chloride coating verified for PVC adhesion performance
- Complies with NEMA RN-1
- UL File Number E230584

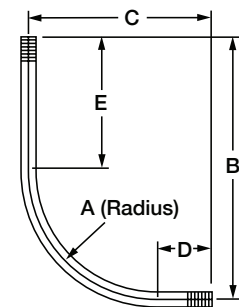

Part Number	Trade Size (in)	Metric Size (mm)	A Standard Radius (in)	B Offset (in)	T Tangent (in)	Weight per 100 (lbs)
PA0590YL00	½ X 90°	4.00	6.19	2.19	14.00	18.00
PA0790YL00	¾ X 90°	4.50	6.75	2.25	13.50	18.00
PA1090YL00	1 X 90°	5.75	8.63	2.88	12.25	18.00
PA1290YL00	1¼ X 90°	7.25	10.25	3.25	12.25	19.25
PA1590YL00	1½ X 90°	8.25	11.63	3.38	12.25	20.50
PA2090YL00	2 X 90°	9.50	14.50	5.00	12.00	21.50
PA2590YL00	2½ X 90°	10.50	16.00	5.50	12.00	22.50
PA3090YL00	3 X 90°	13.00	19.25	6.25	12.00	25.00
PA3590YL00	3½ X 90°	15.00	22.75	7.75	12.00	27.00
PA4090YL00	4 X 90°	16.00	24.00	8.00	12.00	28.00

All dimensions are for informational purposes only \*Tolerances +/- 5%



For more info visit [calbond.com](http://calbond.com)